

**Proposed Estimate for Construction of Watch Tower at Uliara of Bhora Beat of Radhanagar Range**  
**Head of Service :-2406-01-102-SP-026-50-00-V**

As per PWD SOR wef 01.11.2017 with up to date corrigendum

Sl. No.	PWD Sch. Page /Item No	Description of Items	No.	Length (M)	Width (M)	Depth (M)	Quantity	Total Quantity	Unit	Rate (Rs.)	Amount (Rs.)
<b>A. BUILDING WORKS</b>											
1	Page No - 1 It No. - 1	Surface dressing of brown in any kind of soil including removing vegetation inequalities no exciding 15 cm depth and disposal of rubbish within a lead upto 75 meter as Directd.	1	3.000	3.000	-	9.000				
2	Page No - 1 It No. - 2(a)	Earth work in excavation of foundation trenches or drains, in all sorts of soil (including mixed soil but excluding laterite or sandstone) including removing, spreading or stacking the spoils within a lead of 75 m. as directed. The item includes necessary trimming the sides of trenches, levelling, dressing and ramming the bottom, bailing out water as required complete.						9.000	Sqm	10.00	90.00
		(a) Depth of excavation not exceeding 1,500 mm.									
		For Column foundation	4	1.20	1.20	1.20	6.912				
3	Page No - 2 It No. - 4(a)	(A) Filling in foundation or plinth by silver sand in layers not exceeding 150 mm as directed and consolidating the same by thorough saturation with water, ramming complete including the cost of supply of sand. (payment to be made on measurement of finished quantity)						6.912	% Cum	11927.00	824.39
		(B) Do - by fine sand									
		FOUNDATION									
		1/3 rd of total excavation					2.304				
4	Page No - 14 It No. - 1	Single Brick Flat Soling of picked jhama bricks including ramming and dressing bed to proper level and filling joints with local sand.						2.304	% Cum	37521.00	864.48
		FOUNDATION									
		Column	4	1.20	1.20	-	5.760				
5	Page No - 34 It No. - 22(iii)(a)	Cement concrete 6:3:1 with 32mm down graded gravel						5.760	Sqm	294.00	1,693.44
		FOUNDATION									
		Column	4	1.20	1.20	0.100	0.576				
								0.576	Cu.M.	3255.00	1,874.88
6	Page No - 26 It No. - 10(i)	Ordinary Cement concrete (mix 1:1.5:3) with graded stone chips (20 mm nominal size) excluding shuttering and reinforcement if any, in ground floor as per relevant IS codes. Local variety crusher broken.									
		Column footing	4	1.200	1.200	0.150	0.864				
		Do	4	0.600	0.600	0.300	0.432				
		Do	4	0.250	0.250	7.000	1.750				
		Tie Beam	8	2.500	0.250	0.250	1.250				
		Roof	1	2.500	2.500	0.100	0.625				
		Stair	15	0.900	0.250	0.150	0.506				
		Landing	3	0.900	1.500	0.150	0.608				
			3	0.900	0.900	0.100	0.243				
7	Page No - 42 It No. - 36 (a)	Hire and labour charges for shuttering with centering and necessary staging upto 4 m using approved stout props and thick hard wood planks of approved thickness with required bracing for concrete slabs, beams and columns, lintels curved or straight including fitting, fixing and striking out after completion of works (upto roof of ground floor)						6.278	Cu.M.	4888.00	30,686.86
		(a) 25 mm to 30 mm thick wooden shuttering as per decision & direction of Engineer-In-Charge.									
		Column	4	7.000	1.000	-	28.000				
		Tie Beam	8	0.500	0.250	-	1.000				
		Roof	1	2.500	2.500	-	6.250				
		Stair	15	0.900	0.150	-	2.025				
		Landing	3	1.500	0.900	-	4.050				
			3	0.900	0.900	-	2.430				
							43.755	Sq.m	321.00		14,045.36



Sl. No.	PWD Sch. Page /Item No	Description of Items	No.	Length (M)	Width (M)	Depth (M)	Quantity	Total Quantity	Unit	Rate (Rs.)	Amount (Rs.)
8	Page No - 44 It No. - 40(a) (2nd corrigendum dated 18.04.2018)	Reinforcement for reinforced concrete work in all sorts of structures including distribution bars, stirrups, binders etc initial straightening and removal of loose rust (if necessary), cutting to requisite length, hooking and bending to correct shape, placing in proper position and binding with 16 gauge black annealed wire at every intersection, complete as per drawing and direction.									
		(a) For works in foundation, basement and upto roof of ground floor/upto 4 m									
		(i) Tor steel/Mild Steel									
		I. SAIL/ TATA/RINL					@ 1.5% of R.C.C.	0.739	M.T.	71269.00	52,667.79
9	Page No - 15 It No. - 8	Brick work with 1st class bricks in cement mortar (1:6)									
		(b) In superstructure, ground floor									
		Parapet wall	4	2.500	0.250	0.900	2.250				
10	Page No - 16 It No. - 16	125 mm thick brick work with 1st class bricks and cement mortar (1:4) in ground floor						2.250	Cu.M	4728.00	10,638.00
		Side Wall of stair	6	1.500	0.900		8.100				
								8.100	Sq.m	625.00	5,062.50
11	Page No - 4 It No. - 3	Supplying and laying Polythene Sheet (150gm / sq.m.) over damp proof course or below flooring or roof terracing or in foundation or in foundation trenches.									
		Column	4	7.000	1.000	-	28.000				
		Tie Beam	8	0.500	0.250	-	1.000				
		Roof	1	2.500	2.500	-	6.250				
		Stair	15	0.900	0.150	-	2.025				
			3	1.500	0.900	-	4.050				
		Landing	3	0.900	0.900	-	2.430				
								43.755	Sqm	24.00	1,050.12
12	Page No - 48 It No. - 6	Artificial stone in floor, dado, staircase etc with cement concrete (1:2:4) with stone chips, laid in panels as directed with topping made with ordinary or white cement (as necessary) and marble dust in proportion (1:2) including smooth finishing and rounding off corners including raking out joints or roughening of concrete surface and application of cement slurry before flooring works using cement @ 1.75 kg/sq.m all complete including all materials and labour. (3rd Corrigendum dated 04.06.2018)									
		25 mm thick									
		Roof Slab	1	2.500	-	2.500	6.250				
		Stair	15	0.900	-	0.400	5.400				
		Landing	3	0.900	-	0.900	2.430				
								14.080	Sq. M	250.00	3,660.80
13	Page No - 189 It No. - 1	Plaster (to wall, floor, ceiling etc.) with sand and cement mortar including rounding off or chamfering corners as directed and raking out joints including throating, nosing and drip course, scaffolding/staging where necessary (Ground floor). [Excluding cost of chipping over concrete surface]									
		(ii) With 1:4 cement mortar (Inside Plaster)									
		(b) 15 mm thick plaster In outside wall									
		Column	4	1.000	-	7.000	28.000				
		Beam	8	2.500	-	1.000	20.000				
		Side Wall of stair	12	1.500	-	0.900	16.200				
		Parapet Wall	8	2.500	-	0.900	18.000				
								82.200	Sq. M	150.00	12,330.00
14	Page No - 192 It No. - 15	Neat cement punning about 1.5mm thick in wall, dado, window sill, floor etc. NOTE: Cement 0.152 cu.m per 100 sq.m.									
		Outside	4	2.50	-	0.366	3.660				
								3.660	Sq. M	34.00	124.44
15	Page No - 196 It No. - 8	Applying Exterior grade Acrylic primer of approved quality and brand on plastered or concrete surface old or new surface to receive decorative textured (matt finish) or smooth finish acrylic exterior emulsion paint including scraping and preparing the surface thoroughly, complete as per manufacturer's specification and as per direction of the EIC.									
		(b) Two Coats									
		(Same as item no 20 a Plastered Area)						82.200	Sq. M	45.10	3,707.22







This architectural drawing shows a cross-section of a staircase. The total width of the staircase structure is indicated as 6000. A specific section of the landing or platform is labeled with a width of 700. The drawing illustrates the structural layout, including the stairs and the supporting walls.

**CROSS SECTION OF ROOF BEAM**

## AT MID SPAN

## FOUNDATION OF COLUMN

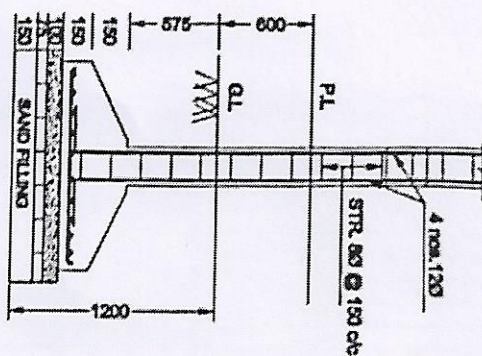
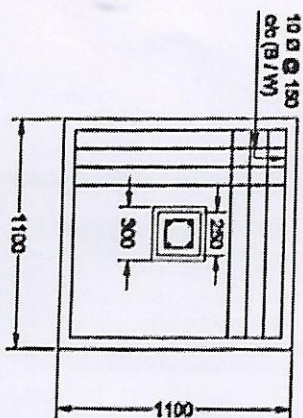

Divisional Forest Officer  
Bankura North Division



**Proposed Estimate for Construction of Aatchala at Sonamukhi Range**

**Head of Service :-2406-01-789-SP-011-50-00-V**

**As per PWD SOR wef 01.11.2017 with up to date corrigendum**

Sl. No.	Description of Items	No.	Length (M)	Width (M)	Depth (M)	Quantity	Total Quantity	Unit	Rate (Rs.)	Amount (Rs.)
<b>A. BUILDING WORKS</b>										
1	Earth work in excavation of foundation trenches or drains, in all sorts of soil (including mixed soil but excluding laterite or sandstone) including removing, spreading or stacking the spoils within a lead of 75 m. as directed. The item includes necessary trimming the sides of trenches, levelling, dressing and ramming the bottom, bailing out water as required complete.									
	(a) Depth of excavation not exceeding 1,500 mm.									
	For Column foundation	8	1.20	1.20	1.30	14.976				
	Tie Beam	2	5.25	0.25	0.30	0.788				
	Tie Beam	2	4.75	0.25	0.30	0.713				
	Steps	2	5.50	1.00	0.30	3.300				
							19.777	% Cum	11927.00	2,358.80
2	(A) Filling in foundation or plinth by silver sand in layers not exceeding 150 mm as directed and consolidating the same by thorough saturation with water, ramming complete including the cost of supply of sand. (payment to be made on measurement of finished quantity)									
	(B) Do - by fine sand									
	<b>FOUNDATION</b>									
	1/3 rd of total excavation					6.592				
	For Column foundation	8	1.20	1.20	0.15	1.728				
	Tie Beam	2	5.25	0.25	0.10	0.263				
	Tie Beam	2	4.75	0.25	0.10	0.238				
	Steps	2	5.50	1.00	0.10	1.100				
	Plinth	1	5.00	5.00	0.60	15.000				
							24.921	% Cum	37521.00	9,350.73
3	Supplying and laying Polythene Sheet (150gm / sq.m.) over damp proof course or below flooring or roof terracing or in foundation or in foundation trenches.									
	Column	8	1.200	1.200	-	11.520				
	Tie Beam	1	5.250	0.250	-	1.313				
							12.833	Sqm	25.00	320.83
4	Single Brick Flat Soling of picked jhama bricks including ramming and dressing bed to proper level and filling joints with local sand.									
	<b>FOUNDATION</b>									
	Floor	1	5.00	5.00	-	25.000				
							25.000	Sqm	293.00	7,325.00
5	Cement concrete 4:2:1 with graded stone chips (20 mm nominal size) excluding shuttering and reinforcement if any, in ground floor									
	<b>FOUNDATION</b>									
	Column	8	1.20	1.20	0.075	0.864				
	Floor	2	5.50	5.50	0.070	4.235				
							5.099	Cu M.	5228.14	26,658.29
6	Ordinary Cement concrete (mix 1:1.5:3) with graded stone chips (20 mm nominal size) excluding shuttering and reinforcement if any, in ground floor as per relevant IS codes. Local variety crusher broken.									
	Column footing	8	1.200	1.200	0.175	2.016				
	Do	8	0.700	0.700	0.236	0.925				
	Do	8	0.250	0.250	4.250	2.125				
	Tie Beam	2	5.250	0.250	0.250	0.656				
		2	4.750	0.250	0.250	0.594				
	Lintel	2	5.250	0.250	0.150	0.394				
		2	4.750	0.250	0.150	0.356				
	Wall Beam	2	5.250	0.250	0.250	0.656				
		2	4.750	0.250	0.250	0.594				
	Roof	1	5.500	5.500	0.125	3.781				
	Chaja	4	5.950	0.450	0.075	0.803				
							12.900	Cu M.	5825.01	75,142.63

Sl. No.	Description of Items	No.	Length (M)	Width (M)	Depth (M)	Quantity	Total Quantity	Unit	Rate (Rs.)	Amount (Rs.)
7	200 mm thick Brick work with fly ash bricks in cement mortar (1:6)									
	a) In foundation and plinth									
	Wall	4	4.750	0.230	0.600	2.622				
		2	5.500	0.250	0.300	0.825				
		2	5.500	0.250	0.150	0.413				
		2	5.500	0.250	0.150	0.413				
		2	5.500	0.250	0.150	0.411				
							4.684	Cu M	4533.00	21,234.16
8	100 mm thick Brick work with fly ash bricks in cement mortar (1:6)									
	Above Lintel									
	Wall	4	4.750		0.650	12.350				
		4	5.500		0.450	9.900				
							22.250	Cu.M	526.00	11,703.50
9	Hire and labour charges for shuttering with centering and necessary staging upto 4 m using approved stout props and thick hard wood planks of approved thickness with required bracing for concrete slabs, beams and columns, lintels curved or straight including fitting, fixing and striking out after completion of works (upto roof of ground floor)									
	(a) 25 mm to 30 mm thick wooden shuttering as per decision & direction of Engineer-In-Charge.									
	Column	8	4.300	0.175	-	6.020				
		8	1.000	3.900	-	31.200				
	Tie Beam	2	5.250	0.250	-	2.625				
		2	4.750	0.350	-	3.325				
		2	5.250	0.150	-	1.575				
		2	4.750	0.150	-	1.425				
		2	5.250	0.200	-	2.100				
		2	4.750	0.200	-	1.900				
		4	4.750	0.300	-	5.700	55.870	Sq.m	203.00	11,341.61
	Roof	1	5.000	5.000	-	25.000				
		4	5.950	0.450	-	10.710				
							35.710	Sq.m	321.00	11,462.91
10	Reinforcement for reinforced concrete work in all sorts of structures including distribution bars, stirrups, binders etc initial straightening and removal of loose rust (if necessary), cutting to requisite length, hooking and bending to correct shape, placing in proper position and binding with 16 gauge black annealed wire at every intersection, complete as per drawing and direction.									
	(a) For works in foundation, basement and upto roof of ground floor/upto 4 m									
	(i) Tor steel/Mild Steel									
	I. SAIL/ TATA/RINL						1.215	M.T.	55629.00	67,589.24
11	Plaster (to wall, floor, ceiling etc.) with sand and cement mortar including rounding off or chamfering corners as directed and raking out joints including throating, nosing and drip course, scaffolding/staging where necessary (Ground floor). [Excluding cost of chipping over concrete surface]									
	c) 10mm thick plaster									
	Ceiling	1	5.000	-	5.000	25.000				
							25.000	Sq. M	121.00	3,025.00
	(ii) With 1:6 cement mortar (Inside Plaster)									
	(b) 15 mm thick plaster In outside wall									
	Out side	1	22.000	-	1.000	22.000				
	Inside	1	22.000	-	0.900	19.800				
	Parapet	4	5.500	-	0.450	9.900				
	Chajja	8	5.950	-	0.450	21.420				
	Steps	2	5.500	-	1.500	16.500				
							89.620	Sq. M	133.00	11,919.46





# PLAN FOR CONSTRUCTION OF ATCHALA

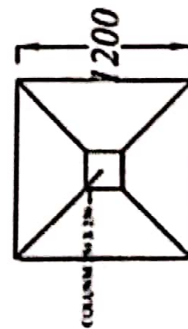
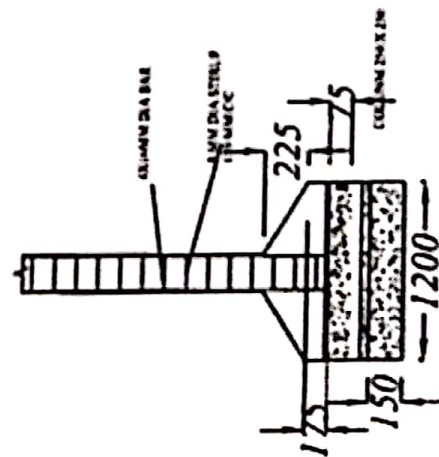

DETAILS OF FOUNDATION  
C2

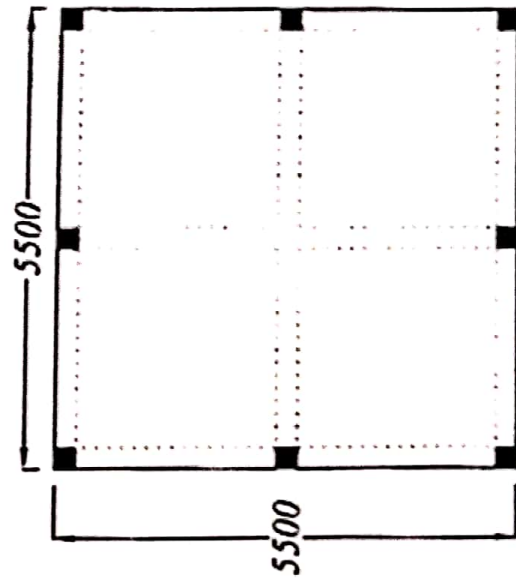
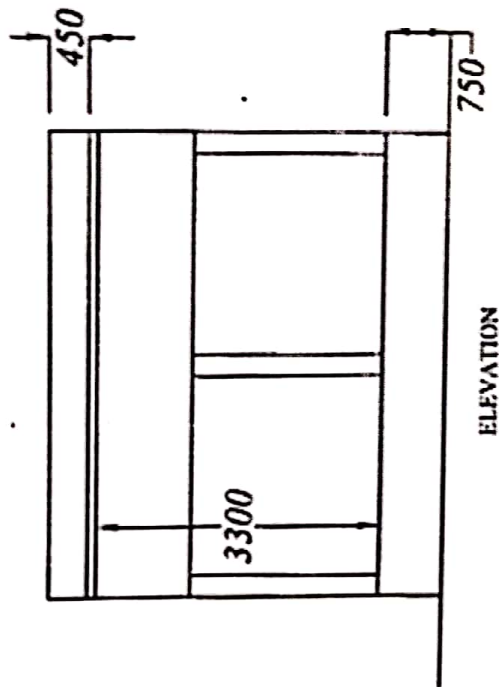

Divisional Forest Officer  
Bankura (North) Division



ANNEXURE - A

8. Other Expenditure Economic Rehabilitation of Fringe Population .  
Estimate for Supply of Agricultural Implements

Head of Service :- 2406-01-796-SP-022-50-00-V

As per PWD SOR wef 01.11.2017

Sl.No.	Particulars	Qty	Unit	Rate	Total Amount
1	MAYUR brand 24" Double Gear Paddle Thresher C I Thali fitted with 24 nos MS Channel (FMTTI) including all taxes	1	No	8,000.00	8,000.00
	For 16 Nos Paddy Thresher				1,28,000.00

Rupees One Lakh Twenty Eight Thousand Only

  
Divisional Forest Officer  
Bankura (North) Division



**ESTIMATE FOR PROTECTION & CONTROL OPERATION FOR WILD LIFE MITIGATION IN  
BANKURA (NORTH) DIVISION  
UNDER H/S 2406-02-796-SP-008-ELEPHANT CONSERVATION- 50-00-V  
ESTIMATE FOR SUPPLY OF CROP PROTECTION EQUIPMENTS]  
[ ANNEXURE A ]**

SL NO.	DESCRIPTION OF ITEM	QUANTITY	UNIT	RATE(Rs.)	AMOUNT
1	Being cost of supply of items for protection & control operation for wildlife mitigation at Barjora, Beliatore, Sonamukhi, Radhanagar, Patrasayer, G.Ghali, Mejhia & Bankura (North) Range in Bankura (North) Division.				
a.	Cost of supply of crop protection equipment	9514	Nos.	50	4,75,700.00
<b>Total</b>					<b>4,75,700.00</b>

[Rupees Four lakh seventy five thousand seven hundred only]

  
 Divisional Forest Officer  
 Bankura ( North) Division



**ESTIMATE FOR PROTECTION & CONTROL OPERATION FOR WILD LIFE MITIGATION IN  
BANKURA (NORTH) DIVISION  
UNDER H/S 2406-02-796-SP-008-ELEPHANT CONSERVATION- 50-00-V  
ESTIMATE FOR SUPPLY OF CROP PROTECTION MATERIALS  
[ ANNEXURE B]**

SL. NO.	DESCRIPTION OF ITEM	QUANTITY	UNIT	RATE(Rs.)	AMOUNT
1	Being the cost of supply of items for protection & control operation for wildlife mitigation at Barjora, Beliatore, Sonamukhi, Radhanagar, Patrasayer, G.Chati, Mejhia & Bankura (North) Range in Bankura				
a.	Cost of Supply Crop protection materials	11845	Ltr.	40	4,73,800.00
	<b>Total</b>				<b>4,73,800.00</b>

[Rupees Four lakh seventy three thousand eight hundred only]

  
Divisional Forest Officer  
Bankura ( North) Division



# 1. Development of Forest Communication

## Estimate for Construction of Concrete Road at Lokpur under Bankura (North) Range

Head of Service :- 2406-01-070-SP-001-50-00-V

As per PWD SOR wef 01.11.2017

SI	Description of items	Quantity	Unit	Rate	Amount
1	Box cutting in road embankment and construction of sub - grade in all sorts of soil including spreading the spoils properly over the flank as necessary or on brem to approximate grade & camber and rolling the sub grade with power roller to proper camber & grade as per direction and satisfaction of Engineer-in-charge including uprooting & removing plants and jungles when & where necessary (a) depth above 150 mm and upto 300 mm) Page No - 238/ Item no 3.16(A) of PW R & B 61.01 X 3.00 = 183.03 sqm	183.03	Sqm	33.40	6113.20
2	Supplying,spreading and compacting fine Sand to required thickness,in layers not exceeding 150 mm to proper gradient and camber,inundating each layer by water and packing and ramming layer by layer to achieve desired compaction,including lighting,guarding,barricading and making adequate earthen bundh where neccessary,curing with water as per direction,mending cracks and depressions by ramming wherever necessary. Page No - 244/ Item no 4.05 of PW R & B 61.01 X 3.00 X 0.150 = 27.45 cum	27.45	Cum	664.10	18229.55
3	Supplying and laying polytheen sheet (150 gm/sqm) over damp proof course or below flooring or roof terracing or in foundation or in foundation trenches. Page No - 47/ Item no 3 of PW Building 61.01 X 3.00 = 183.03 sqm	183.03	Sqm	24.00	4392.72
4	Providing form work and staging inclduing hire and labour charges for the same as required for foundation concrete wroks of depth not exceeding 500 mm. and for concrete works in vertical faces of parapet kerb, road kerb, cable tray, cable tray cover, rail post so as to give good concrete finish including stripping off and removing after completion of work as per specification. Page No - 42/ Item no 36(b) of PW Building 2.00 X 61.01 X 0.150 = 18.30 sqm	18.30	Cum	214.00	3916.20
5	Providing & Laying cement concrete with or without reinforcements if any part of foundation/sub structure/super structure or bridge /culverts with graded stone chips/gravels/bajree of specified nominal sizes including screening & cleaning of coarse aggregates and sand , cost of curing with water including cost and cariage of all materials but excluding cost of form work and reinforcement works complete. ( 1:2:4 concrete) Analysis rate attached 61.01 X 3.00 X 0.150 = 27.45 cum	27.45	Cum	5021.23	137832.76
	Providing expansion joints in concrete pavement including supplying/placing 25 mm thick and 150 mm wide thermocal strip including filling the joints Page No - 332/ Item no 18.7(a) of PW R & B 20.34 X 3.00 = 61.01 Mtr	61.01	Mtr	20.00	1220.20
	Total cost of Construction Work			Rs.	1,71,704.63
	Add GST @ 12%			Rs.	20,604.56
	Total			Rs.	1,92,309.19
	Add Labour welfare cess @ 1%			Rs.	1,923.09
	Add Contingency @ 3%			Rs.	5,769.28
	GRAND TOTAL			Rs.	2,00,001.55
	Or Say			Rs.	2,00,000.00

(Rupees Two Lakhs Only)

Divisional Forest Officer  
Bankura (North) Division



## Construction of Concrete Road

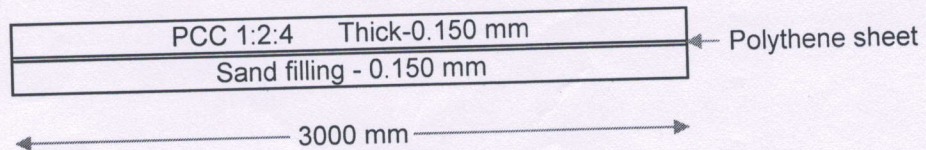

**Cross Section**

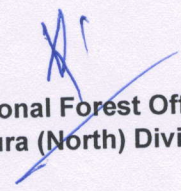
  
Divisional Forest Officer  
Bankura (North) Division



# 1. Development of Forest Communication

## Estimate for construction of Drainage System at Lokpur under Bankura (North) Range

Head of Service :- 2406-01-070-SP-001-50-00-V

As per PWD SOR wef 01.11.2017

SI. No	PWD Sch. Rate Page no. & Item No	Particulars of Work	Unit	Vol/Qty	Rate	Amount
1	P-1/2(a)	Earth work in excavation of foundation trenches or drains, in all sorts of soil (including mixed soil but excluding laterite or ndstone) including removing, spreading or stacking the spoils within a lead of 75 m. as directed. The item includes necessary trimming the sides of trenches, levelling, dressing and ramming the bottom, bailing out water as required complete. a) Depth of excavation not exceeding 1,500 mm.				
		37.50 m x 1.100 m x 0.900 m	% Cum	37.125	11927.00	4,427.90
2	Page No.2 4(B) It.	Sand filling in foundation trenches and at the back of abutments, wing walls etc. with good local sand free from earth in layers not exceeding 15 cm. including inundating each layer by profuse water and poking and ramming layer by layer complete including supply of sand to be approved by EIC and plinth in layer not exceeding 15 cm. as directed and consolidating same by through saturation with water and ramming complete including cost of supply of sand ( Payment to be made on measurement of finished quantity)				
		50 m x 1.100 m x 0.100 m	%Cum	4.125	48741.00	2,010.57
3	Page No.14 It. 1	Single Brick Flat Soling of picked jhama bricks including ramming and dressing bed to proper level and filling joints with local sand.				
		50 m x 1.10 m	Sqm	41.25	294.00	12,127.50
4	Page no-24 Item - 4 (d)	Ordinary Cement concrete (mix 1:2:4) with graded stone chips (20 mm nominal size) excluding shuttering and reinforcement, if any, in ground floor as per relevant IS codes. (d) With local hard blackstone variety chips (crusher broken)				
		37.50 m x 1.10 m x 0.10 m = 4.125 m <sup>3</sup>				
		37.50 m x 2 sides x 0.25 m x 0.625 m = 11.718 m <sup>3</sup>	Cum	15.8430	4218.00	66,825.77
5	Page No.42 It. 36 (a)	Hire and labour charges for shuttering with centering and necessary staging upto 4 m using approved stout props and thick hard wood planks of approved thickness with required bracing for concrete slabs, beams and columns, lintels curved or straight including fitting, fixing and striking out after completion of works (upto roof of ground floor) (a) 25 mm to 30 mm thick wooden shuttering as per decision & direction of Engineer-In- Charge.				
		37.50 m x 2 sides x 2 sides x 0.625 m	Sqm	93.75	321.00	30,093.75
6	Page no-24 Item - 4 (d)	Ordinary Cement concrete (mix 1:2:4) with graded stone chips (20 mm nominal size) excluding shuttering and reinforcement, if any, in ground floor as per relevant IS codes. (d) With local hard blackstone variety chips (crusher broken)				
		1 No x 1.20 m x 0.15 m x 3.00 m = 0.54 m <sup>3</sup>	Cum	0.54	4218.00	2,277.72
7	Page No.42 It. 36 (a)	Hire and labour charges for shuttering with centering and necessary staging upto 4 m using approved stout props and thick hard wood planks of approved thickness with required bracing for concrete slabs, beams and columns, lintels curved or straight including fitting, fixing and striking out after completion of works (upto roof of ground floor) (a) 25 mm to 30 mm thick wooden shuttering as per decision & direction of Engineer-In- Charge.				
		1 No x 1.50 m x 3.30 m = 4.95 m <sup>2</sup>	Sqm	4.95	321.00	1,586.95

8	Page no -44 Item - 40(a)(i)	Reinforcement for reinforced concrete work in all sorts of structures including distribution bars, stirrups, binders etc initial straightening and removal of loose rust (if necessary), cutting to requisite length, hooking and bending to correct shape, placing in proper position and binding with 16 gauge black annealed wire at every intersection, complete as per drawing and direction) Tor steel/Mild Steel(2nd corrigendum dated 18.04.2018) ]				
		0.54 m3 x 1.5% x 7850/1000	MT	0.0636	53888.00	3,426.47
9		Polythene sheet, Expansion joint etc.	Ls			5,998.85
		Sub total				1,28,777.48
Add GST @ 12%					Rs.	15,453.30
Total including GST					Rs.	1,44,230.77
Add Labour Cess @ 1%					Rs.	1,442.31
Add Contingency @ 3 %					Rs.	4,326.92
Total Estimated Value					Rs.	1,50,000.01
Total Estimated Value					Rs.	1,50,000.00

(Rupees One Lakh Fifty Thousands Only)



Divisional Forest Officer  
Bankura (North) Division



## Construction Concrete Drain

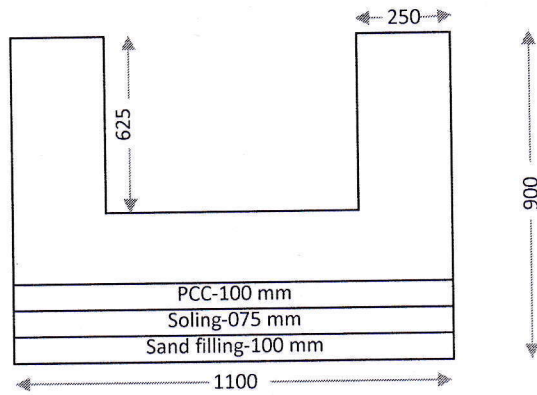

Divisional Forest Officer  
Bankura (North) Division